



BEFORE

AFTER

FACT FILE

THE OWNERS

Fiona and Tim Peregrine

THE PROPERTY

A Victorian semi-detached house

LOCATION

Chiswick, west London

WHAT THEY SPENT

The couple spent £30,382 on extending and renovating their kitchen and dining area

Left Aluminium and glass folding doors link the kitchen to the patio area outside for flexible entertaining. A distinctive part of the overall design, they cost around £5,000 and fill the room with light. For similar, try The Folding Sliding Door Company

TOP TIP
The horizontal grain on these unit doors is a great contemporary look and also helps the room seem wider



Transformed!

RELAXED MODERN KITCHEN

Fiona and Tim Peregrine have used a combination of polished granite and warm wood tones to create an inspiring kitchen in their newly extended Victorian home

THE PROBLEM

Fiona and Tim Peregrine hated the long, narrow kitchen in their Victorian semi. The couple struggled to prepare meals in the cramped workspace, which was fitted with units that were falling apart.

THE SOLUTION

Remove two of the exterior walls and extend out to create a large open-plan kitchen and dining area. Pull down the ceiling, reinsulate and put in two large rolled steel joists to support the new folding patio doors. Replace the

old fittings with glossy Parapan units, Zebrano veneered doors and black granite worktops for a contemporary look, with neutral porcelain floor tiles to reflect light around the room. Choose sleek-looking appliances and hang paintings for a splash of colour.

HOW IT WAS DONE

'We saw the house in August 2006 and immediately spotted its potential, so we didn't hesitate in buying it, despite the huge amount of work that was needed to bring it up to date. Although the house was structurally sound, it hadn't been renovated in quite some time.

'We weren't in a hurry at that stage to get the whole house done, but as one job started, it created another and we soon decided that we might as well go for it and do all the building work at once to get it over with. It rapidly became chaotic, with builders everywhere dismantling walls and pulling down ceilings. We suddenly found ourselves living in a building site! However, I was glad to see the old units

ripped out of the grotty kitchen and when the two external walls were removed and the new extension built, we were amazed at the huge space it created.

'We knew we wanted clean modern lines in our new kitchen and looked at everything available on the market, from the high-end designs that we couldn't afford to budget options. My husband has an engineering background and drew up the plans to include everything we needed, so it was just a case of finding the right designer to interpret our vision.

'I happened to find Higham Furniture's website when I was browsing the internet and fell in love with some of the kitchens in their gallery. Tim Higham came to visit us and we clicked with him straight away. ▶



Above The kitchen extension created space for Fiona's dining furniture. She bought the 50s Rio rosewood table by Robert Heritage for Archie Shine for £550 on Ebay and teamed it with vintage Ligne Roset chairs in beech, also bought a few years ago from an antiques shop **Left** Fiona couldn't wait to find a place for her chunky bar stools in her new kitchen. For similar, try the Funky 207 bar stool from Furniture 123

PLANS

Before

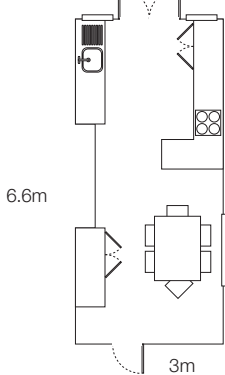

After

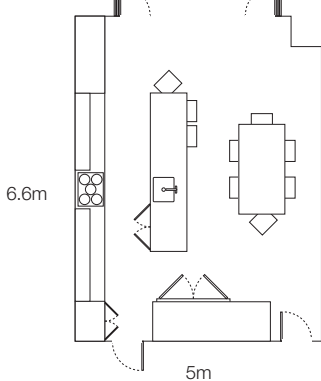

COSTS

KITCHENSUITE	£15,010
APPLIANCES & FURNITURE	£14,311
WALLS & FLOOR	£1,061

Kitchen suite: Bespoke Parapan and Zebrano veneer units, £11,500 (plus £1,610 for fitting), Higham Furniture. Absolute black granite work surfaces, £110 per m² (total including supply and fitting, £1,900), Domostone

Appliances & furniture: Fridge-freezer, £1,530, Liebherr. G2222 SCu dishwasher, £700; B1664 Series 6 single ovens, £1,000 each (total, £2,000); B6784 microwave combi oven, £900; N7290 warming drawer, £400; D8250 Series 6 extractor, £800, all Neff. KG 291 hob, £2,000, Gaggenau. RGX 120 stainless-steel sink, £280, Franke. Tube Rinse brushed stainless-steel tap, £380, Blanco. Aluminium folding doors, £5,000 (for similar try The Folding Sliding Door Company). Flos Fucsia 1 pendant lights, £107 each (total, £321), icône

Walls & floor: Shaded White modern emulsion, £25 for 2.5L; Shaded White eggshell paint, £36.50 for 2.5L, both Homebase. Polished Purestone sandstone floor tiles, £1,000 total, StoneFlair

TOTAL £30,382



'The kitchen is great for entertaining friends and family, but we also love lounging around here with the paper on lazy Sunday mornings'



Top Artworks give the kitchen a more furnished and relaxed feel. Fiona bought the large oil painting by Lee Johnson eight years ago, specifically for use in her dream kitchen! **Above** A breakfast bar has been incorporated into the elongated island to provide a social, informal dining area

I told him we wanted something with a very modern appearance, but with all the traditional dovetailing and handmade features behind it. His level of interest and commitment to our kitchen was amazing and really inspired confidence.

'We sourced our own appliances, and as my husband is a very keen cook, he insisted on a powerful Gaggenau gas hob. We chose Neff products from its latest range, which have very few dials or buttons, giving them a sleek look. We asked the builders to make a tall unit out of MDF to house the Liebherr fridge-freezer and painted it the same colour as the walls, so it would blend in.

'It took eight months to complete the house, but the kitchen was installed in just a week. When the large folding doors were fitted and the flooring laid we were

astounded by the transformation. I couldn't wait to get my dining furniture in and hang our well-loved paintings. I feel this kitchen very much reflects our personalities because of all the numerous decisions we made to arrive at the finished result. I don't think we've done anything radical, but we've created a great space that appeals to everyone and it sits well within our home.

'The kitchen is great for entertaining friends and family, especially because of the folding patio doors that link it to the garden. It's also a really calm space, just wonderful for lazy Sunday mornings lounging around with a newspaper and a coffee. We have a TV in the room but rarely switch it on. My husband says it's as lovely as he expected, but for me it's better than I could ever have imagined.'

WORDS CAROLINE FOSTER PHOTOGRAPHS COLIN POOLE